



GRUPPO SOSTA art. 219

Gruppo Sosta - acciaio inox AISI 316L
Belay Station - Stainless steel AISI 316L
Desquelgue – inoxidable AISI 316L
Ensemble - inox AISI 316 L

MADE IN ITALY



Art. 219

2 ROCK Ø10 + 2 catene + 1 anello Ø10 + 1 R5000

Peso Weight Peso Poids 497 g



Inserire la corda nel moschettone
 Put the rope in the carabiner
 Inserte la cuerda en el mosquetone
 Insérez la corde dans le mousqueton

OK!

Art. 219

Nomenclatura Nomenclature

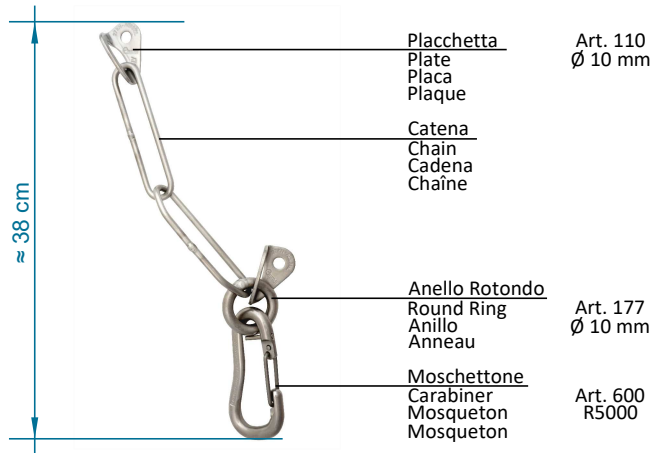

Vedi le schede tecniche dei singoli prodotti CE e UIAA: art.218 e art.600
 See the technical data sheets of the singol products CE and UIAA: art.218 and art.600
 Ver las fichas técnicas de los productos individuales CE y UIAA: art.218 y art.600
 Voir les fiches techniques des différents produits CE et UIAA: art.218 et art.600

Resistenza effettiva della placchetta
 Effective strenght of the plate
 Resistencia efectiva de la placa
 Résistance effective de la plaque

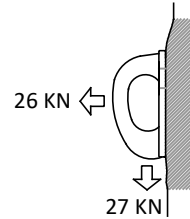

Resistenza effettiva del moschettone
 Effective strenght of the carabiner
 Resistencia efectiva del mosqueton
 Résistance effective du mosqueton

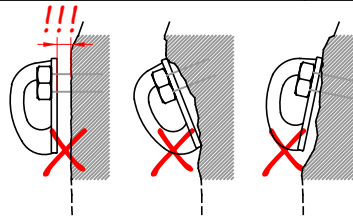
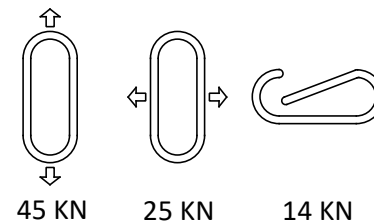

**WARNING,
DANGER!!!**

Calata regolata dal basso
 Abseil descent
 Descenso en rapél
 Descente en moulinette



Corda
 Rope
 Cuerda
 Corde

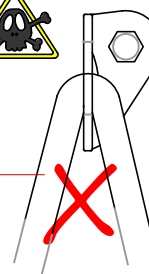

Non inserire la corda nella catena per la Calata regolata dal basso
 Do not put the rope in the chain for the Abseil descent
 No ponga la cuerda en la cadena por hacer Descenso en rapél
 Ne pas mettre la corde dans la chaîne pour Descente en moulinette

Esempio di Installazione con Hang Fix - Example of Installation with Hang Fix
 Ejemplo de Instalación con Hang Fix - Exemple d'installation avec Hang Fix

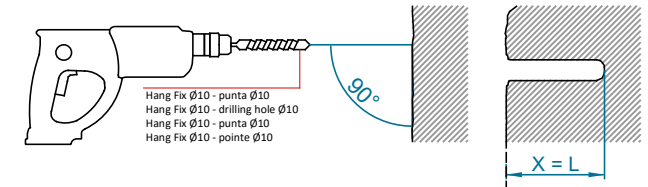

Hang Fix: utilizzare solo su rocce dure e compatte (granito, calcare, ecc...)
 Hang Fix: requires hard compact rock (limestone, granite, dolomite, ecc.)
 Hang Fix: adapto a rocas duras y compactas (Caliza, granito y dolomita, ecc.)
 Hang Fix: utiliser uniquement sur les rochers durs et compactes (calcaire massif, marbre, ecc...)

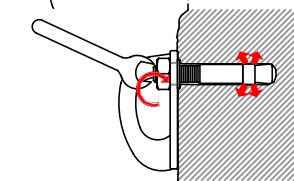
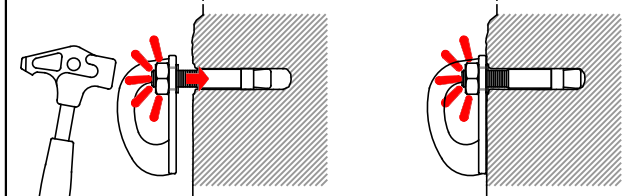

Coppia di serraggio
 Torque
 Par de apriete
 Couple de serrage
 Ø 10 = 30 N * m

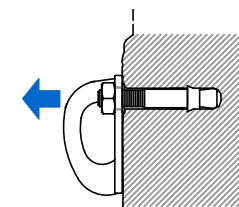

OK!

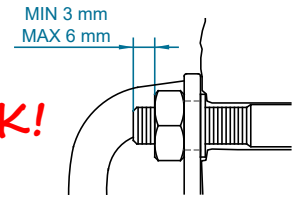

Orientare la placchetta nella direzione del carico
 Orient the plate in the direction of the load
 Orientar la placa en la dirección de la carga
 Orienter la plaque dans la direction de la charge