

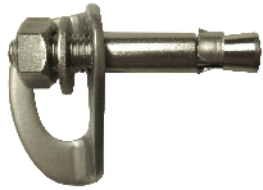

ROCK + HANG FIX

Ancoraggio - acciaio inox AISI 316L
Anchor - Stainless steel AISI 316L
Anclajes - inoxidable AISI 316L
Amarrage - inox AISI 316 L

CONFORMITA'
EN 795:2012
EN 959:2018



Art. 166 - Rock Ø 12 mm +
Art. 109 - Hang Fix inox M12C
 Peso Weight Peso Poids 124 g
 M 12 x 74 mm

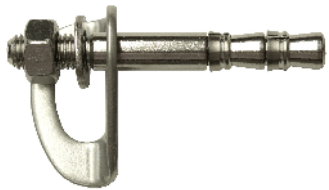

Art. 166 - Rock Ø 12 mm +
Art. 114 - Hang Fix inox M12L
 Peso Weight Peso Poids 144 g
 M12 x 100 mm

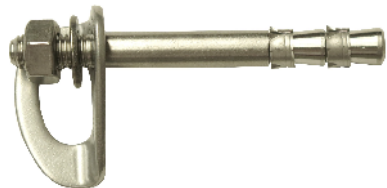

Art. 166 - Rock Ø 12 mm +
Art. 224 - Hang Fix inox M12XL
 Peso Weight Peso Poids 164 g
 M12 x 120 mm



Art. 110 - Rock Ø 10 mm +
Art. 156 - Hang Fix inox M10C
 Peso Weight Peso Poids 94 g
 M10 x 66 mm



Art. 110 - Rock Ø 10 mm +
Art. 157 - Hang Fix inox M10L
 Peso Weight Peso Poids 105 g
 M10 x 86 mm



Art. 110 - Rock Ø 10 mm +
Art. 215 - Hang Fix inox M10AL
 Peso Weight Peso Poids 107 g
 M10 x 86 mm

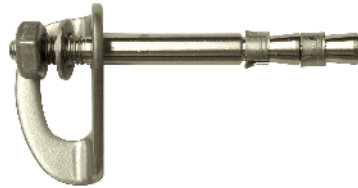

Art. 110 - Rock Ø 10 mm +
Art. 150 - Hang Fix inox M10XL
 Peso Weight Peso Poids 120 g
 M10 x 110 mm

Requisiti resistenza test statico
 Resistance requirements static test
 Exigencias de resistencia prueba estatica
 Exigences de résistance d'essai statique

EN 795:2012 12 KN
 EN 959:2018 15 KN
 UIAA 123 20 KN

EN 795:2012 12 KN
 EN 959:2018 25 KN
 UIAA 123 25 KN



Resistenza effettiva
 Effective strenght
 Resistencia efectiva
 Résistance effective

26 KN
 27 KN

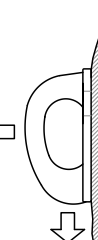

Resistenza effettiva test dinamici
 Dynamic test: effective strength
 Resistencia efectiva pruebas dinamica
 Résistance effective essais dynamiques

EN 795:2012

Load direction	Peak of force (KN)	Deflection of anchor device (mm)	Displacement of anchor point (mm)
A	9.0	15	10
B	9.0	30	25

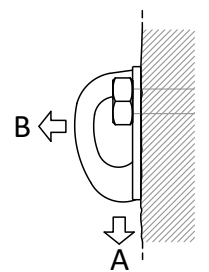

Installazione Installation Installación

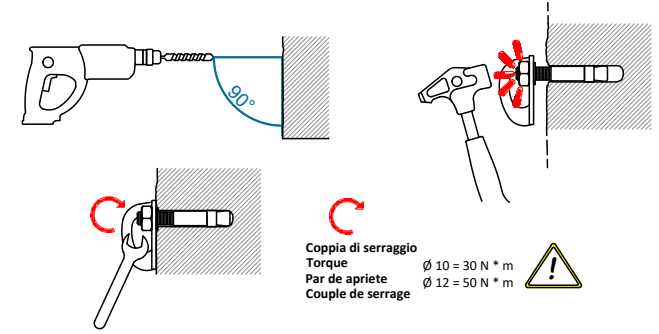

Precauzioni per l'uso
 Precauciones de uso

Precautions for use
 Précautions d'emploi

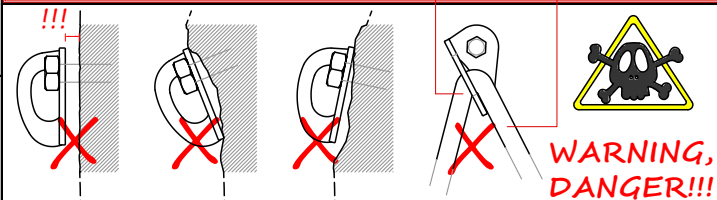
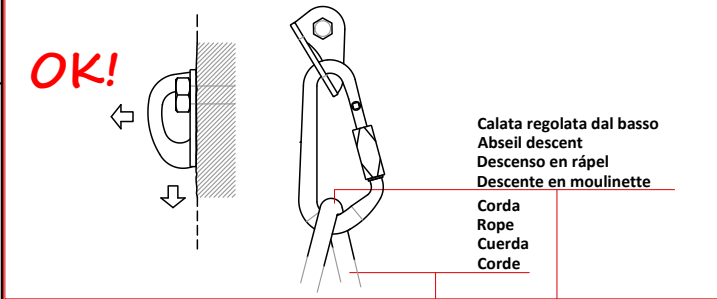

Utilizzare Hang Fix solo in caso di rocce compatte (come calcare massiccio-dolomia) e non in caso di rocce tenere (per esempio l'arenaria) o troppo dure (granito, quartzite).
 Use Hang Fix only in case of compact rocks (such as massif limestone, dolomite) and not in the case of soft rocks (such as sandstone) or too hard (such as granite, quartzite).
 Utilisez Hang Fix solo en caso de rocas compactas (como piedra caliza maciza, dolomita) y no en el caso de la roca blanda (por ejemplo arenisca) o mas duras (como granito y quartzite).
 Utilisez Hang Fix uniquement en cas de roches et compact (comme massif calcaire, dolomite) et non dans le cas de roches tendres (par exemple de grès) ou trop dur (comme quartzite, granite).